

SRB-46/58

A large force is provided by manually operating a lever. Parts such as the pitman arm and tie-rod end can be removed easily with a ring spanner only, without using pneumatic or hydraulic pressure.



	SRB-46	SRB-58
Applicable range	40mm ~ 60mm	50mm ~ 80mm
Maximum output (Safe load)	Approx. 7t	Approx. 12t

* Note that the tool may not be usable with some models due to space limitations.

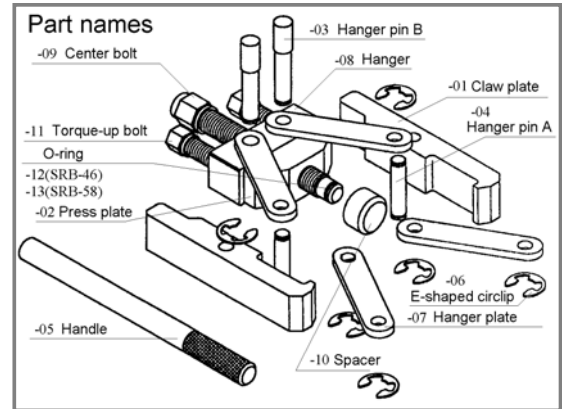
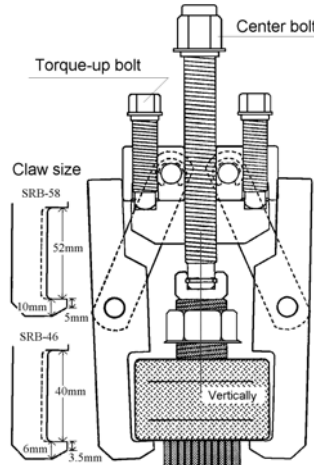

When the center bolt is tightened and then the torque-up bolts are tightened alternately, a larger torque is transmitted by means of the lever action, producing a large output.